

DEERFIELD TOWNSHIP SECTION 33 R13 TWP 9 MORGAN COUNTY, OH

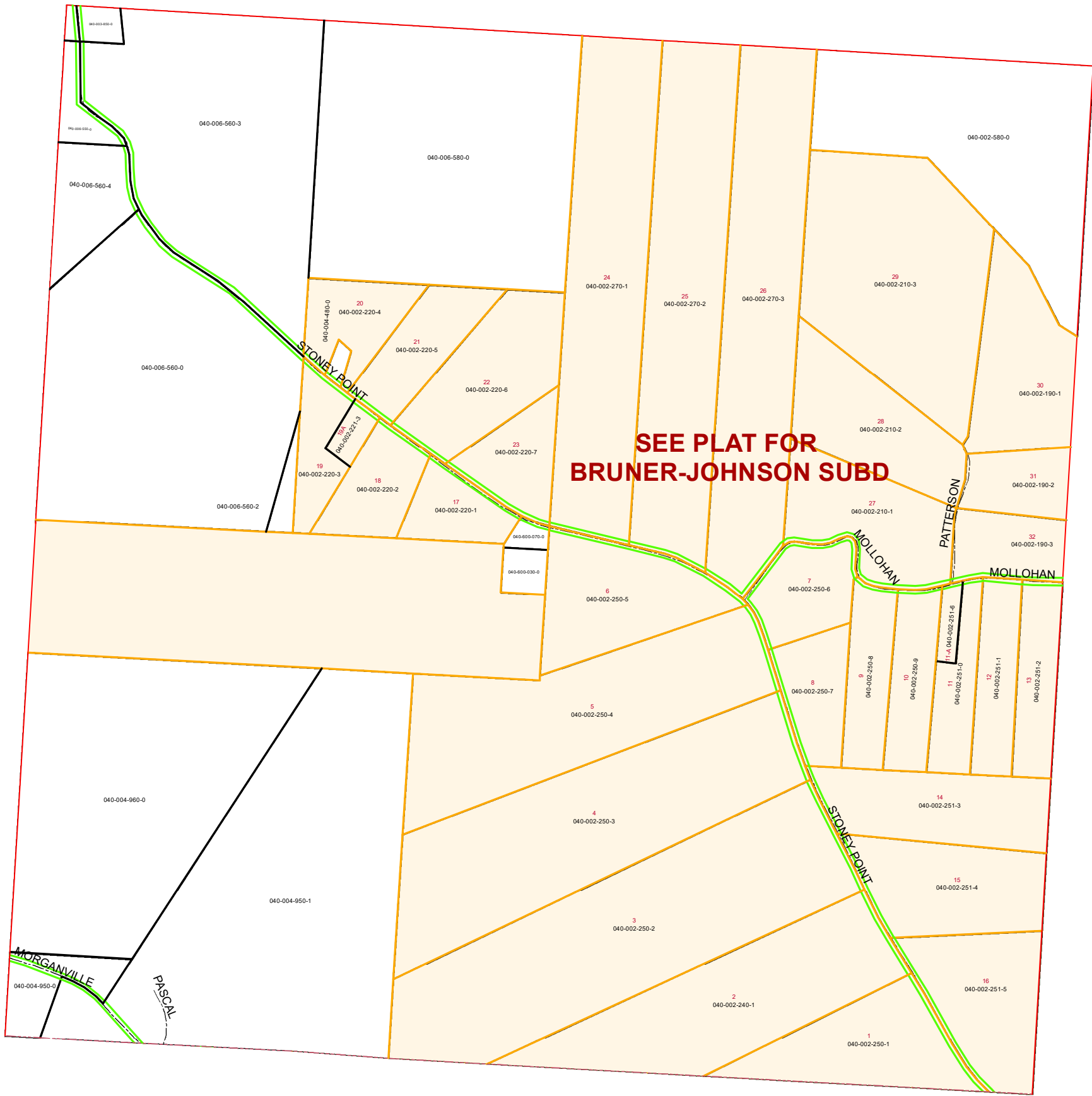

PIN	VOL	PAGE	Owner	LegalDescr	Acres
040-006-560-4	OR226	2034	APPERSON JESSE J & CARY LYNN	R13 T09 S33 SD 28 S	4.964
040-600-030-0			CEMETERY (LOCUST GROVE)	R13 T09 S33 0	0.5
040-600-070-0			CHURCH (LOCUST GROVE)	R13 T09 S33 0	0.5
040-004-950-1	OR207	391	COLLINS RANDY M & RYAN MATTHEW & COURTNEY A COLLINS	R13 T09 S33 SD 26	50.042
040-004-480-0	OR233	2871	DAVIS BARRY E & NANCY E	R13 T09 S33 SD 21 S	0.46
040-004-950-0	OR214	73	HEFNER KEVIN & TAMMY	R13 T09 S33 SD 17 S	3.427
040-004-960-0	OR214	73	HEFNER KEVIN & TAMMY	R13 T09 S33 SD 8 SU	36.781
040-006-560-2	OR169	600	JORDAN RON & MANUELA A	R13 T09 S33 SD 25 S	1
040-006-580-0	OR229	1	PALMER MATTHEW CORY & AMANDA JOYCE	R13 T09 S33 SD 16	41.46
040-006-560-3	OR229	1	PALMER MATTHEW CORY & AMANDA JOYCE	R13 T09 S33 SD 27 S	33.743
040-006-560-1	D.V 190	596	PALMER MICHAEL H & SUSAN JANE	R13 T09 S33 SD 24 S	0.29
040-003-850-0	D.V 164	339	PALMER MICHAEL H & SUSAN W	R13 T09 S33 SD 23 S	0.99
040-002-580-0	OR223	1548	WISEMAN RUSSELL E & DEE ANN	R13 T09 S33 SD 1 SU	27
040-006-550-0	OR219	805	WOODARD JERRELD F JR & MELODY J COPELAND JODIE L FINELY &	R13 T09 S33 SD 22 E	2.001
040-006-560-0	OR224	9	WOODARD JERROLD F & SALLY JEAN	R13 T09 S33 SD 5 EX	37.213

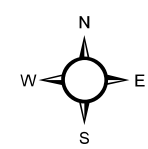

Boundaries		Future Split	Parcel
Type		Hydro	ROW
County	Lot	Section	Township
		Roads	

Source: Morgan County Engineer's Office
 Author: Marcia Wolfe
 Date: 6/2/2020

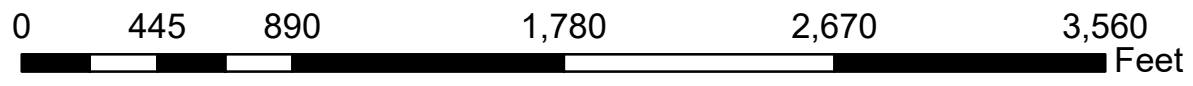

Disclaimer: The information that these maps contains is for reference purposes only. Please bring any errors to the attention of the Engineer's Office staff.
 Thank you